

# JAP6

## 60/200-250 SOLAR PHOTOVOLTAIC MODULE

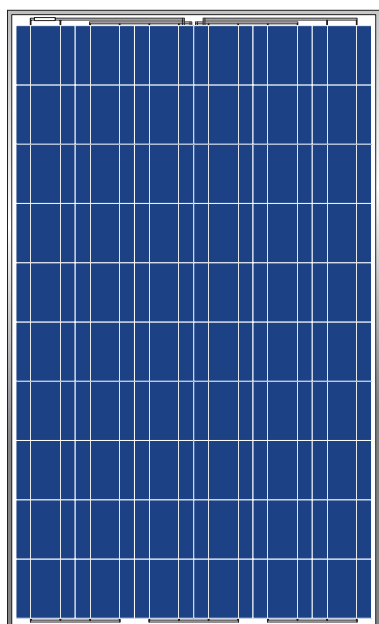

### PRODUCT OVERVIEW

- JA Solar' s modules are optimally manufactured and adjusted to meet the needs of the current market; scientifically designed module dimension makes the installation simple and easy; each cell of the module is the acclaimed "Made by JA Solar".
- Our continuous efforts in quality assurance system and certifications the international authentication institutions of JA Solar' s products demonstrate our commitment to product quality and customer requirements.

### MODULE CHARACTERISTICS

- High efficiency crystalline silicon solar cells.
- High transmission low iron tempered glass, strong mechanical resistance.
- Standard waterproof junction box, with bypass diode.
- High endurance to different atrocious weather.
- Custom designed modules according to clients' requirement.

### MECHANICAL PARAMETERS

Cell(mm)	Poly 156×156
Weight(kg)	19.5
Dimensions(L×W×H)(mm)	1650×991×40 (or×46)
Cable Length(mm)	≥1000
Cable cross section size(mm <sup>2</sup> )	4
No. of cells and connections	60 (10×6)
No. of diodes	3
Packing configuration	25/21pcs/carton

### WORKING CONDITIONS

Maximum System Voltage	DC 1000V(TüV) / 600V(UL)
Operating Temp.	-40°C~+85°C
Maximum Series Fuse (A)	13
Static loading	≤5400Pa
Grounding conductivity	<0.1Ω
NOCT	47±2°C
Application Class	Class A
Insulation Resistance	≥100MΩ

### GUARANTEE

5-year limited product warranty

Limited performance warranty: 10 years at 90% of the minimal rated power output, 25 years at 80% of the minimal rated power output

### JA SOLAR HOLDINGS CO., LTD.

No. 36, Jiang Chang San Road, Zhabei, Shanghai, China, 200436

Tel: +86 (21) 6095 5999 /6095 5888 Fax: +86 (21) 6095 5959 /6095 5858



# JAP6

## 60/200-250 SOLAR PHOTOVOLTAIC MODULE

### I-V CURVE

Output under different irradiation and the correlation between Isc/Voc/ Pmax and Temperature map

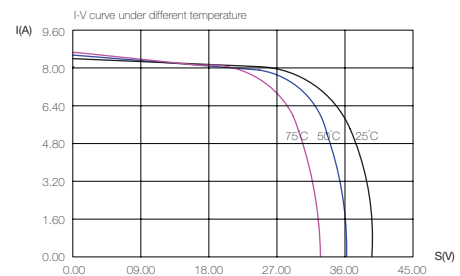
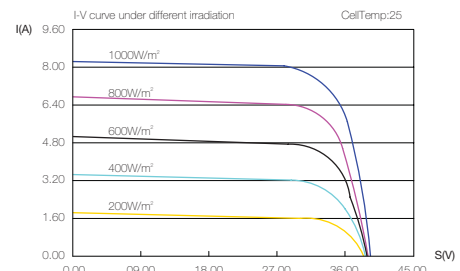
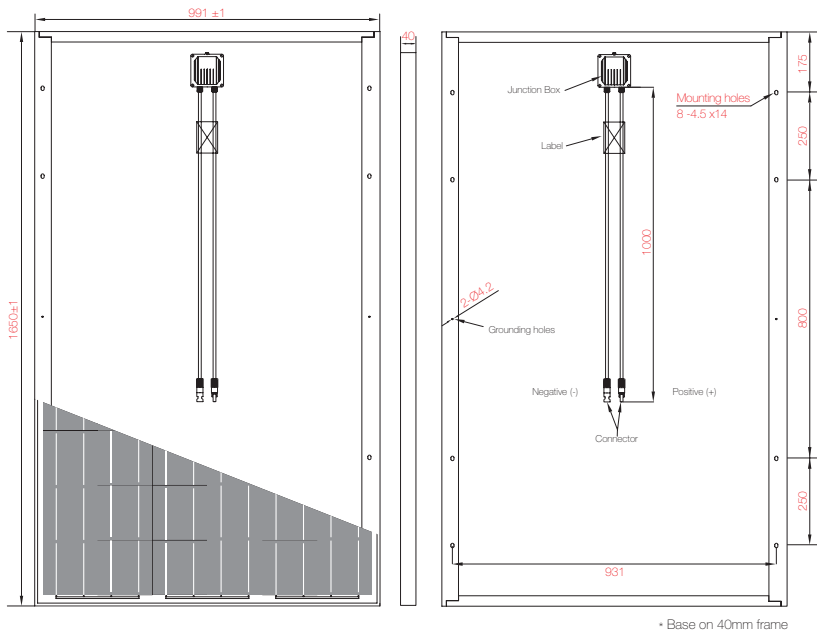

### ELECTRICAL PARAMETERS

TYPE	JAP6-60-200	JAP6-60-205	JAP6-60-210	JAP6-60-215	JAP6-60-220	JAP6-60-225	JAP6-60-230	JAP6-60-235	JAP6-60-240	JAP6-60-245	JAP6-60-250
Rated Maximum Power at STC (W)	200	205	210	215	220	225	230	235	240	245	250
Open Circuit Voltage (Voc/V)	36.15	36.32	36.49	36.66	36.83	37	37.17	37.34	37.51	37.68	37.85
Maximum Power Voltage (Vmp/V)	28.12	28.32	28.52	28.72	28.92	29.12	29.32	29.52	29.72	29.92	30.12
Short Circuit Current (Isc/A)	7.8	7.89	7.97	8.06	8.14	8.23	8.31	8.4	8.48	8.57	8.65
Maximum Power Current (Imp/A)	7.11	7.24	7.36	7.49	7.61	7.73	7.84	7.96	8.08	8.19	8.3
Power Tolerance	±3%										
$\alpha_{Isc}$	0.040%/°C										
$\beta_{Voc}$	-0.304%/°C										
$\gamma_{Pmp}$	-0.420%/°C										

### JA SOLAR HOLDINGS CO., LTD.

No. 36, Jiang Chang San Road, Zhabei, Shanghai, China, 200436

Tel: +86 (21) 6095 5999 /6095 5888 Fax: +86 (21) 6095 5959 /6095 5858

