

# JAM6

## 60/200-250 SOLAR PHOTOVOLTAIC MODULE

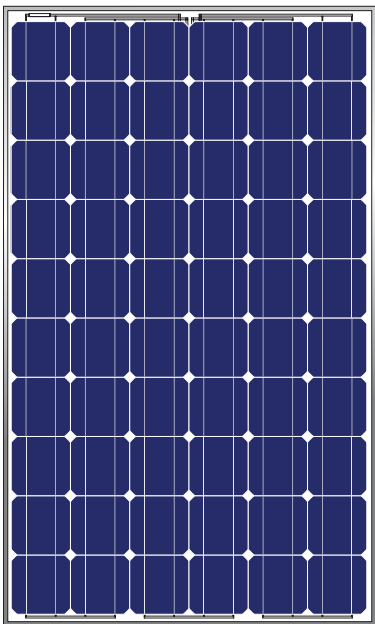

### PRODUCT OVERVIEW

- JA Solar' s modules are optimally manufactured and adjusted to meet the needs of the current market; scientifically designed module dimension makes the installation simple and easy; each cell of the module is the acclaimed "Made by JA Solar".
- Our continuous efforts in quality assurance system and certifications the international authentication institutions of JA Solar' s products demonstrate our commitment to product quality and customer requirements.

### MODULE CHARACTERISTICS

- High efficiency crystalline silicon solar cells.
- High transmission low iron tempered glass, strong mechanical resistance.
- Standard waterproof junction box, with bypass diode.
- High endurance to different atrocious weather.
- Custom designed modules according to clients' requirement.

### MECHANICAL PARAMETERS

Cell(mm)	Mono 156×156
Weight(kg)	19.5
Dimensions(L×W×H)(mm)	1650×991×40 (or×46)
Cable Length(mm)	≥1000
Cable cross section size(mm <sup>2</sup> )	4
No. of cells and connections	60 (10×6)
No. of diodes	3
Packing configuration	25/21pcs/carton

### WORKING CONDITIONS

Maximum System Voltage	DC 1000V(TüV) / 600V(UL)
Operating Temp.	-40°C~+85°C
Maximum Series Fuse (A)	13
Static loading	≤5400Pa
Grounding conductivity	<0.1Ω
NOCT	47±2°C
Application Class	Class A
Insulation Resistance	≥100MΩ

### GUARANTEE

5-year limited product warranty

Limited performance warranty: 10 years at 90% of the minimal rated power output, 25 years at 80% of the minimal rated power output

### JA SOLAR HOLDINGS CO., LTD.

No. 36, Jiang Chang San Road, Zhabei, Shanghai, China, 200436

Tel: +86 (21) 6095 5999 /6095 5888 Fax: +86 (21) 6095 5959 /6095 5858



# JAM6

## 60/200-250 SOLAR PHOTOVOLTAIC MODULE

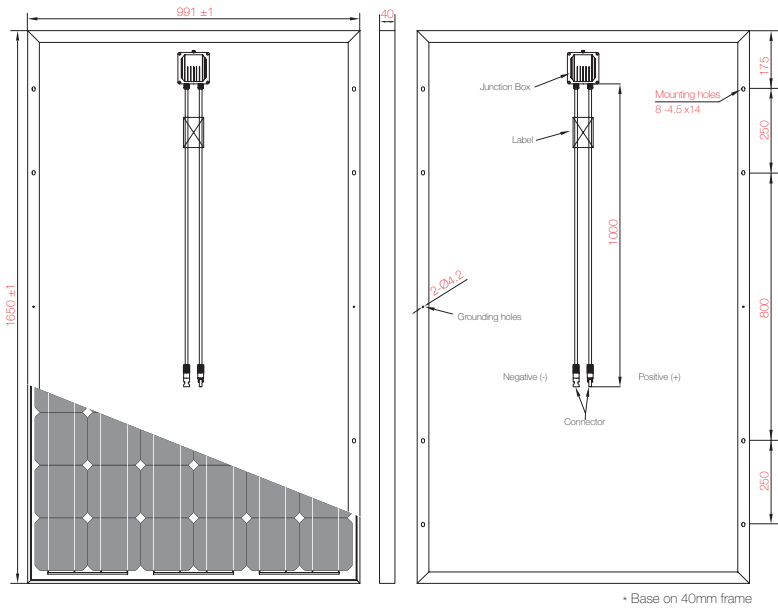

### I-V CURVE

Output under different irradiation and the correlation between Isc/Voc/ Pmax and Temperature map

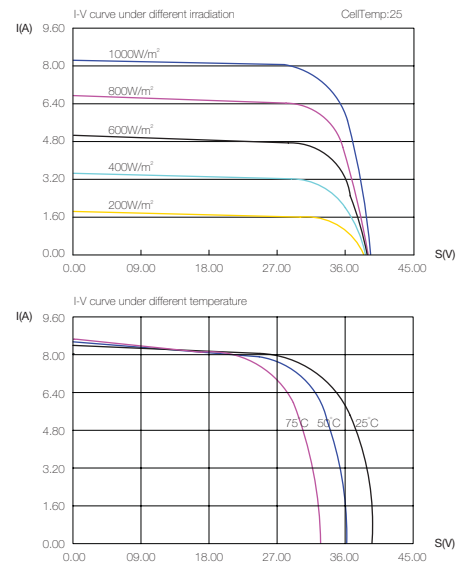

### ELECTRICAL PARAMETERS

TYPE	JAM6-60-200	JAM6-60-205	JAM6-60-210	JAM6-60-215	JAM6-60-220	JAM6-60-225	JAM6-60-230	JAM6-60-235	JAM6-60-240	J-AM6-60-245	JAM6-60-250
Rated Maximum Power at STC (W)	200	205	210	215	220	225	230	235	240	245	250
Open Circuit Voltage (Voc/V)	36.12	36.29	36.46	36.63	36.8	36.97	37.14	37.31	37.48	37.65	37.82
Maximum Power Voltage (Vmp/V)	27.88	28.08	28.28	28.48	28.68	28.88	29.08	29.28	29.48	29.68	29.88
Short Circuit Current (Isc/A)	7.83	7.92	8	8.09	8.17	8.26	8.34	8.43	8.51	8.6	8.68
Maximum Power Current (Imp/A)	7.17	7.3	7.43	7.55	7.67	7.79	7.91	8.03	8.14	8.25	8.37
Power Tolerance	±3%										
$\alpha_{Isc}$	0.037%/°C										
$\beta_{Voc}$	-0.297%/°C										
$\gamma_{Pmp}$	-0.438%/°C										

### JA SOLAR HOLDINGS CO., LTD.

No. 36, Jiang Chang San Road, Zhabei, Shanghai, China, 200436

Tel: +86 (21) 6095 5999 /6095 5888 Fax: +86 (21) 6095 5959 /6095 5858

