

JAM5(L)

72/180-215 SOLAR PHOTOVOLTAIC MODULE

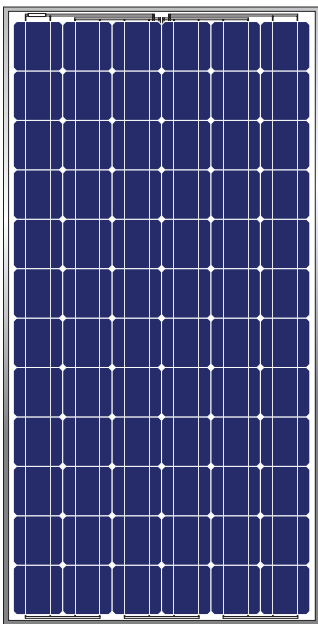

PRODUCT OVERVIEW

- JA Solar' s modules are optimally manufactured and adjusted to meet the needs of the current market; scientifically designed module dimension makes the installation simple and easy; each cell of the module is the acclaimed "Made by JA Solar".
- Our continuous efforts in quality assurance system and certifications the international authentication institutions of JA Solar' s products demonstrate our commitment to product quality and customer requirements.

MODULE CHARACTERISTICS

- High efficiency crystalline silicon solar cells.
- High transmission low iron tempered glass, strong mechanical resistance.
- Standard waterproof junction box, with bypass diode.
- High endurance to different atrocious weather.
- Custom designed modules according to clients' requirement.

MECHANICAL PARAMETERS

Cell(mm)	Mono 125×125 SL
Weight(kg)	15.5
Dimensions(L×W×H)(mm)	1580×808×40
Cable Length(mm)	≥900
Cable cross section size(mm ²)	4
No. of cells and connections	72(12×6)
No. of diodes	3
Packing configuration	25pcs/carton

WORKING CONDITIONS

Maximum System Voltage	DC 1000V
Operating Temp.	-40°C~+85°C
Maximum Series Fuse (A)	10
Static loading	≥2400Pa
Grounding conductivity	<0.1Ω
NOCT	45+/-2°C
Application Class	Class A
Insulation Resistance	≥100MΩ

GUARANTEE

5-year limited product warranty

Limited performance warranty: 10 years at 90% of the minimal rated power output, 25 years at 80% of the minimal rated power output

JA SOLAR HOLDINGS CO., LTD.

No. 36, Jiang Chang San Road, Zhabei, Shanghai, China, 200436

Tel: +86 (21) 6095 5999 /6095 5888 Fax: +86 (21) 6095 5959 /6095 5858



JAM5(L)

72/180-215 SOLAR PHOTOVOLTAIC MODULE

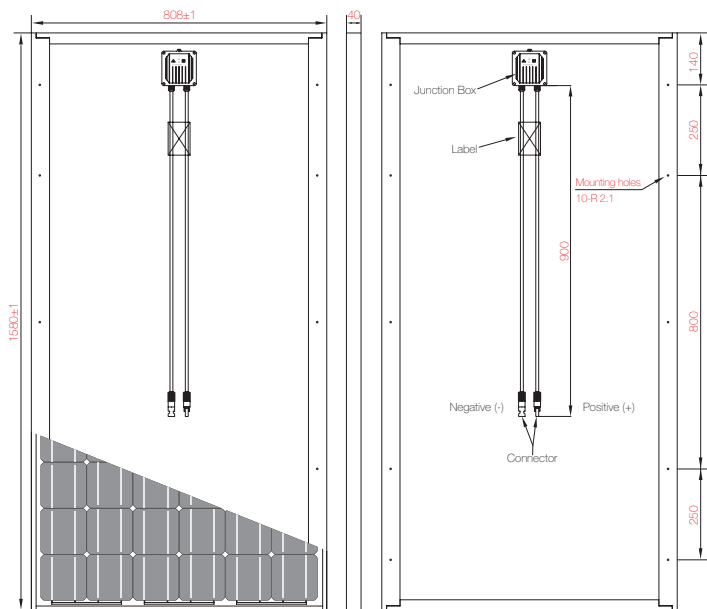

I-V CURVE

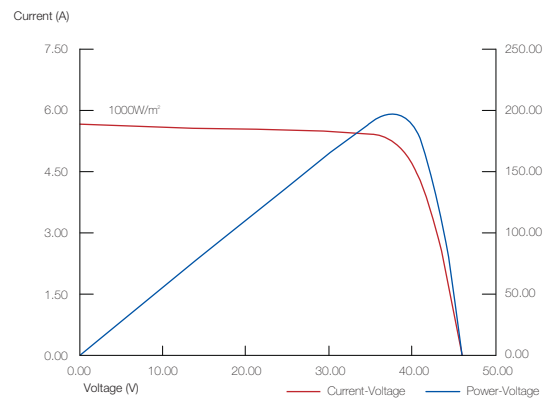

ELECTRICAL PARAMETERS

TYPE	JAM5(L)-72-180/SI	JAM5(L)-72-185/SI	JAM5(L)-72-190/SI	JAM5(L)-72-195/SI	JAM5(L)-72-200/SI	JAM5(L)-72-205/SI	JAM5(L)-72-210/SI	JAM5(L)-72-215/SI
Rated Maximum Power at STC (W)	180	185	190	195	200	205	210	215
Open Circuit Voltage (Voc/V)	44.88	45.18	45.38	45.5	45.62	45.74	45.9	46.1
Maximum Power Voltage (Vmp/V)	36.42	36.54	36.66	36.96	37.26	37.56	37.86	38.16
Short Circuit Current (Isc/A)	5.44	5.52	5.58	5.63	5.66	5.69	5.73	5.79
Maximum Power Current (Imp/A)	4.94	5.06	5.18	5.28	5.37	5.46	5.55	5.63
Power Tolerance	±3%							
α_{Isc}	0.04%/°C							
β_{Voc}	-0.30%/°C							
γ_{Pmp}	-0.44%/°C							

JA SOLAR HOLDINGS CO., LTD.

No. 36, Jiang Chang San Road, Zhabei, Shanghai, China, 200436

Tel: +86 (21) 6095 5999 /6095 5888 Fax: +86 (21) 6095 5959 /6095 5858

